

A-A

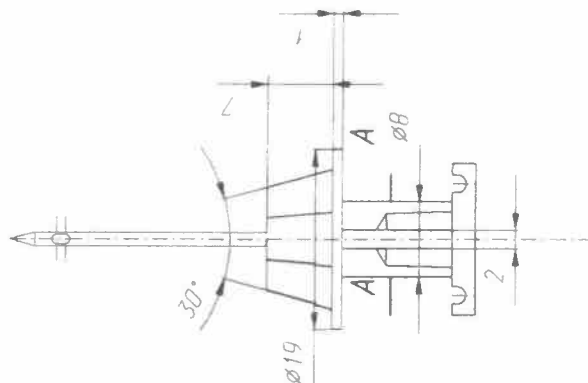
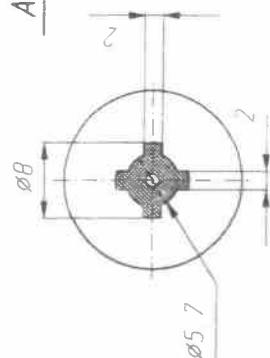

IGŁA POJEDYNCZA

Materiał: stal kwasoodporna w gal.
 rurka: stal kwasoodporna w gal. 1.4303 lub 316L
 nasadka: polipropylen HP371P Purell

nte Bar

SKALA 2.1

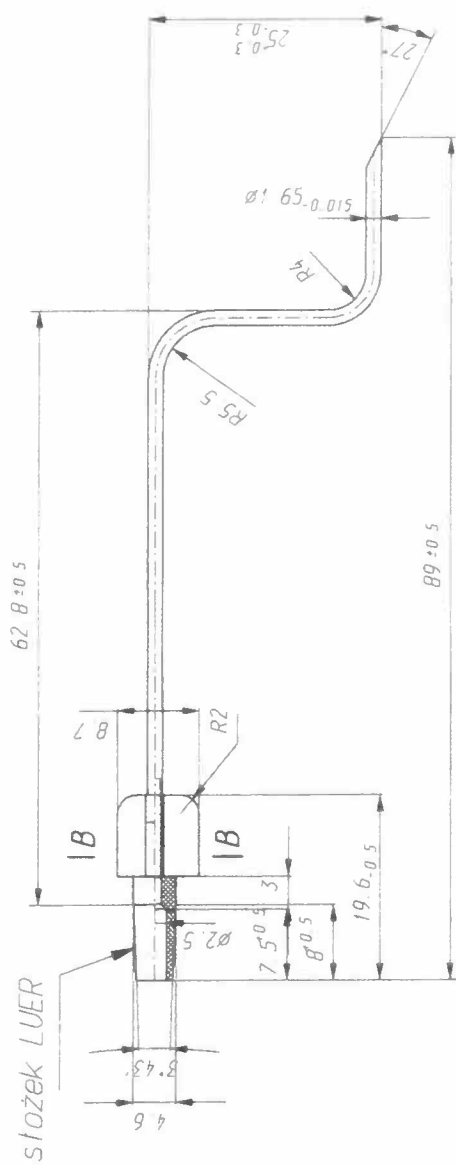
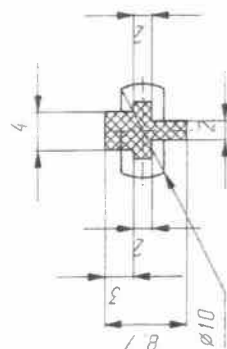

IGŁA SOLI FIZJOLOGICZNEJ

Materiał:
rurka - stal kwasoodporna w gal 1 4303 lub 316L
nasadka- poliipropylen HP371P Purell

Not Bay

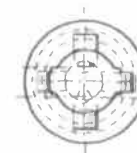
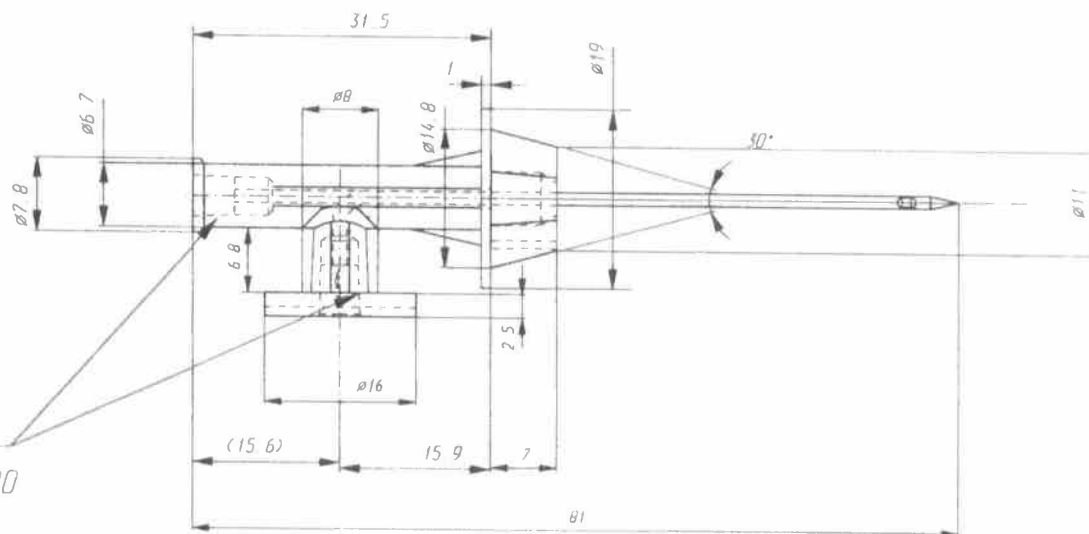

1 GŁA PODWÓJNA

Material

kurka - stal kwasoodporna w gal 1 4303 lub 316L
nasadka- polipropylen HP371P Purell